



MONOCEROS

MS-106 Technical Information Pack



Dimensions: 180 x 220 x 90cm

An elegant elite spa. Room for 3
with impressive massage performance.



MS-106

Dimensions: 180 x 220 x 90cm

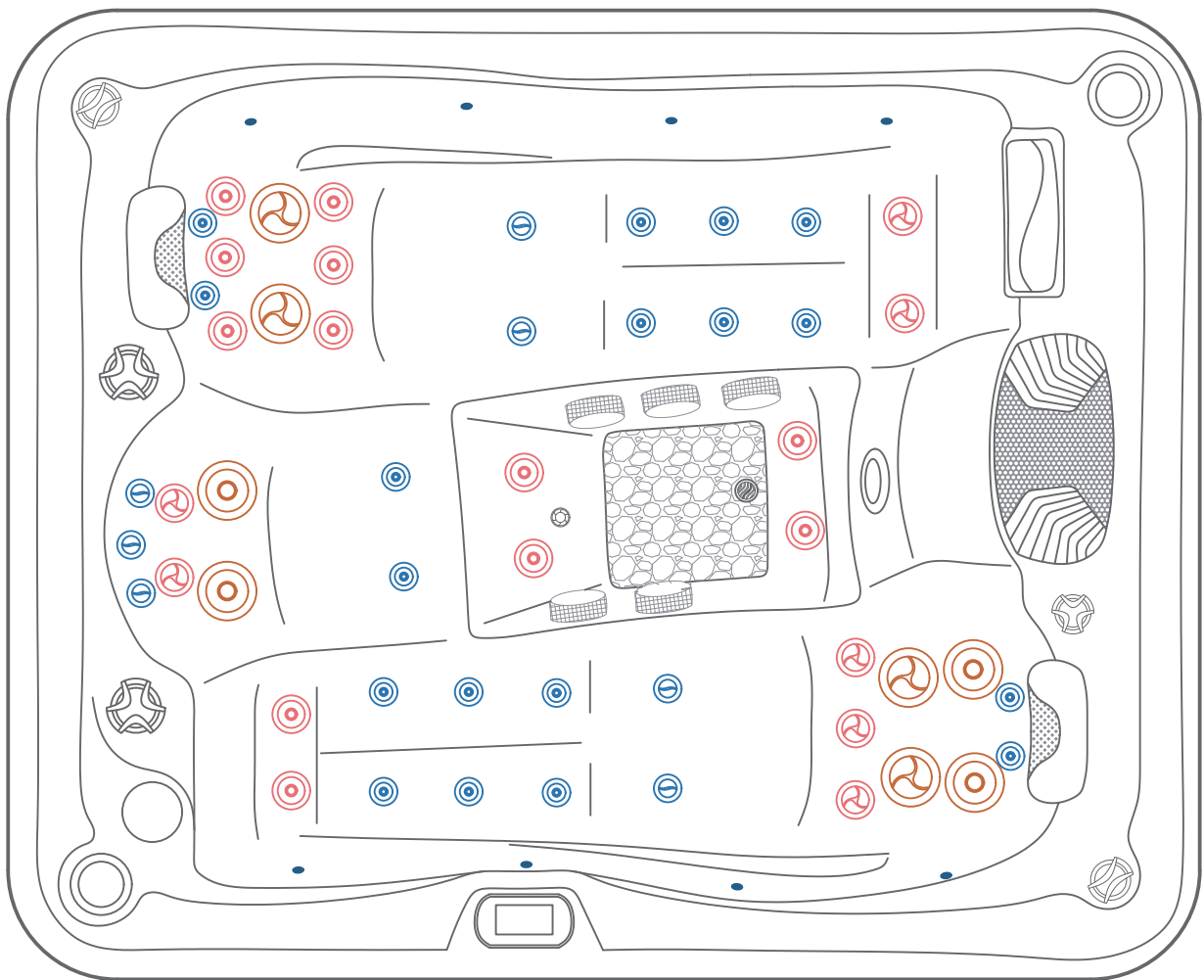

 18 x 2.25" Directional Jets

 12 x 3.5" Directional Jets

 4 x 5" Directional Jets

 7 x 2.25" Impulse-Spining Jets

 7 x 3.5" Impulse-Spining Jets

 4 x 5" Impulse-Spining Jets



MONOCEROS

FILTRATION PLUMBING SPECIFICATIONS

MS-106

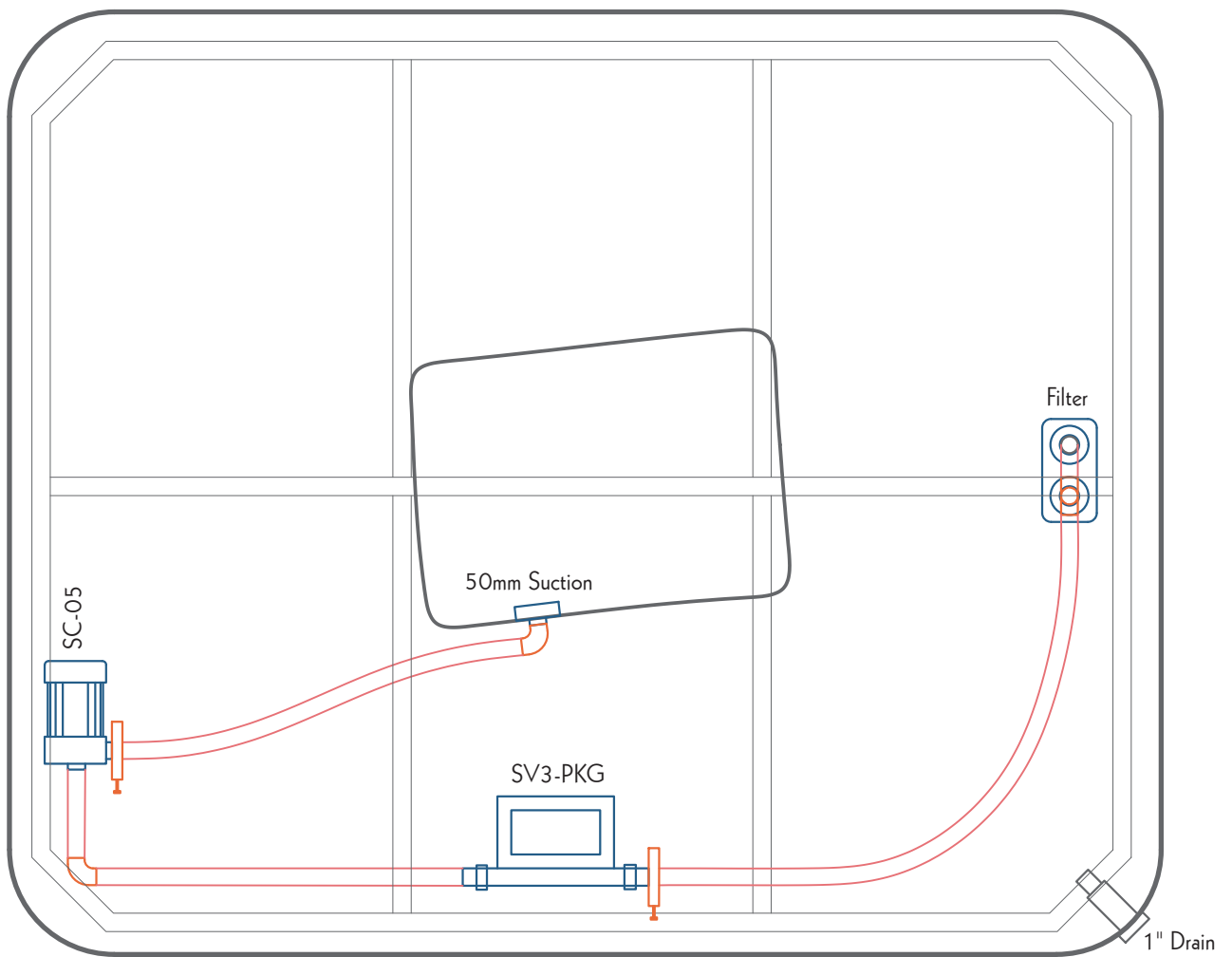



MONOCEROS

PERIPHERAL SPECIFICATIONS

MS-106

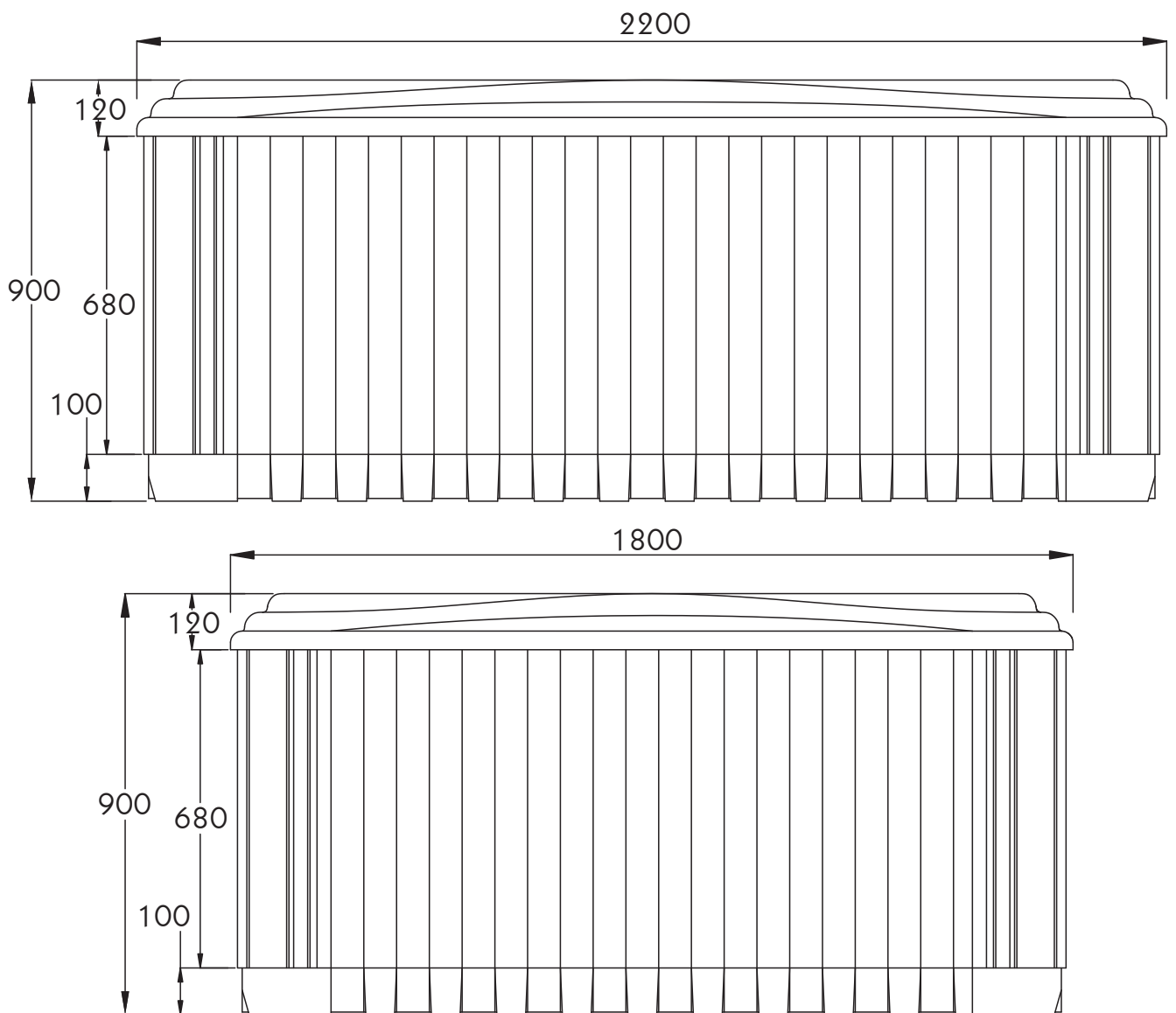



MONOCEROS

COVER SPECIFICATIONS

MS-106

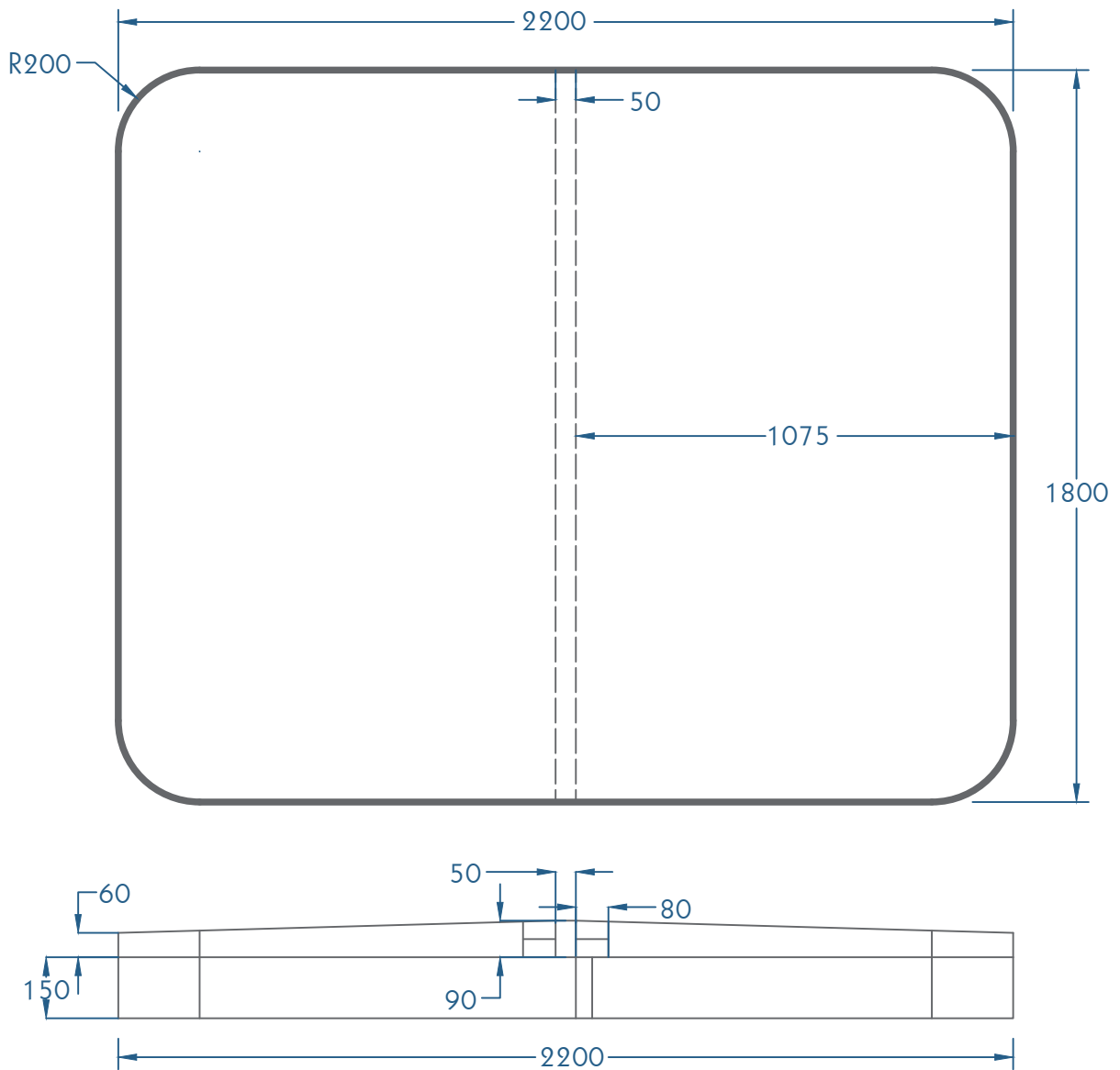

MS-106

Hydrotherapy ★★★★★

Jets 53

Volume 910 liters

Seating 3 persons

Dimensions 1800*2200*900 mm

Seat layout



1. Lounger

2. Captain Seat

3. Lounger



* Specifications will be altered in terms of design and quality improvement considerations.
Notice that such conditions may change without notice.

SPECIFICATIONS

Dry Weight	327kg
Maximum Temp	41 °C
Intuitive Spa Controller	Spanet / Other
Pump Allocation	2.5HP x 2
Circulation Pump	0.5HP x 1
Electrical Requirements	Max 45 amps

FEATURES

- Fiber Reinforced Acrylic Shell
- Durable Cabinet
- Perimeter Insulation
- Ozone Water Clarification
- Molded Curving Base
- Structurally Hard Frame
- Stunning Spa Light System
- Outdoor Steps
- Efficiently Operational Plumbing
- Crystal Illuminated Cascade
- High-Density Foam Cover
- Stainless Steel Jets
- Relaxing Lounger Seats
- Stereo Music System
- SmartZone™ Massage Area

OPTIONS

- UV Water Purification
- WiFi App-Based Control
- Extra Cabinet Insulation

WARRANTIES

Frame	Frame Lifetime
Shell structure	10 years
Acrylic surface	5 years
Jets, plumbing & heater	5 years
Pumps & equipment	2 years